

MD-110 SERIES MODELS

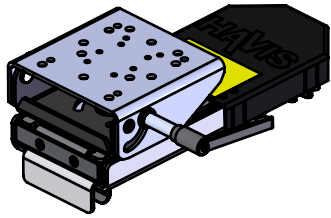

C-MD-112

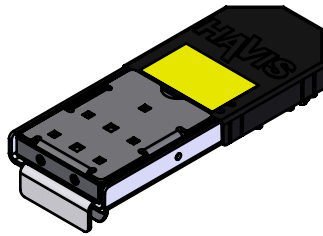

C-MD-114

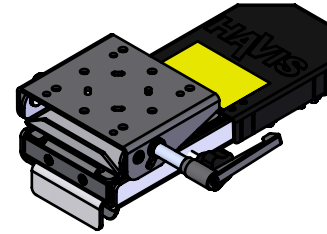

C-MD-119

REV.	DESCRIPTION
7-16	RELEASED TO PRODUCTION
9-16	ADDED C-MD-111 & C-MD-113
3-17	REMOVED C-MD-111 & C-MD-113 REFERENCES
10-19	UPDATED TO REFLECT NEW RIVETED TILT SWIVEL
2-20	GSM34061 WAS GSM34063
10-21	UPDATED TO REFLECT DESIGN CHANGES

SURFACE MOUNTING INSTRUCTIONS

MD-110 SERIES MOTION DEVICES CAN BE MOUNTED TO ANY FLAT SURFACE, INCLUDING CONSOLE TOPS AND HDM POLES. IF SURFACE DOES NOT HAVE PREDRILLED HOLES, USE THE DRILL TEMPLATE TO THE RIGHT.

- PLACE MD-110 SERIES ON TOP OF MOUNTING SURFACE, ALIGNING THE MOUNTING SPACER AND (4) STANDOFFS OF MD-110 SERIES BASE WITH THE (4) 1/4" HOLES THROUGH MOUNTING SURFACE.
- INSTALL THE (4) FLANGE NUTS AS SHOWN IN THE DIAGRAM BELOW.
- TIGHTEN ALL HARDWARE.

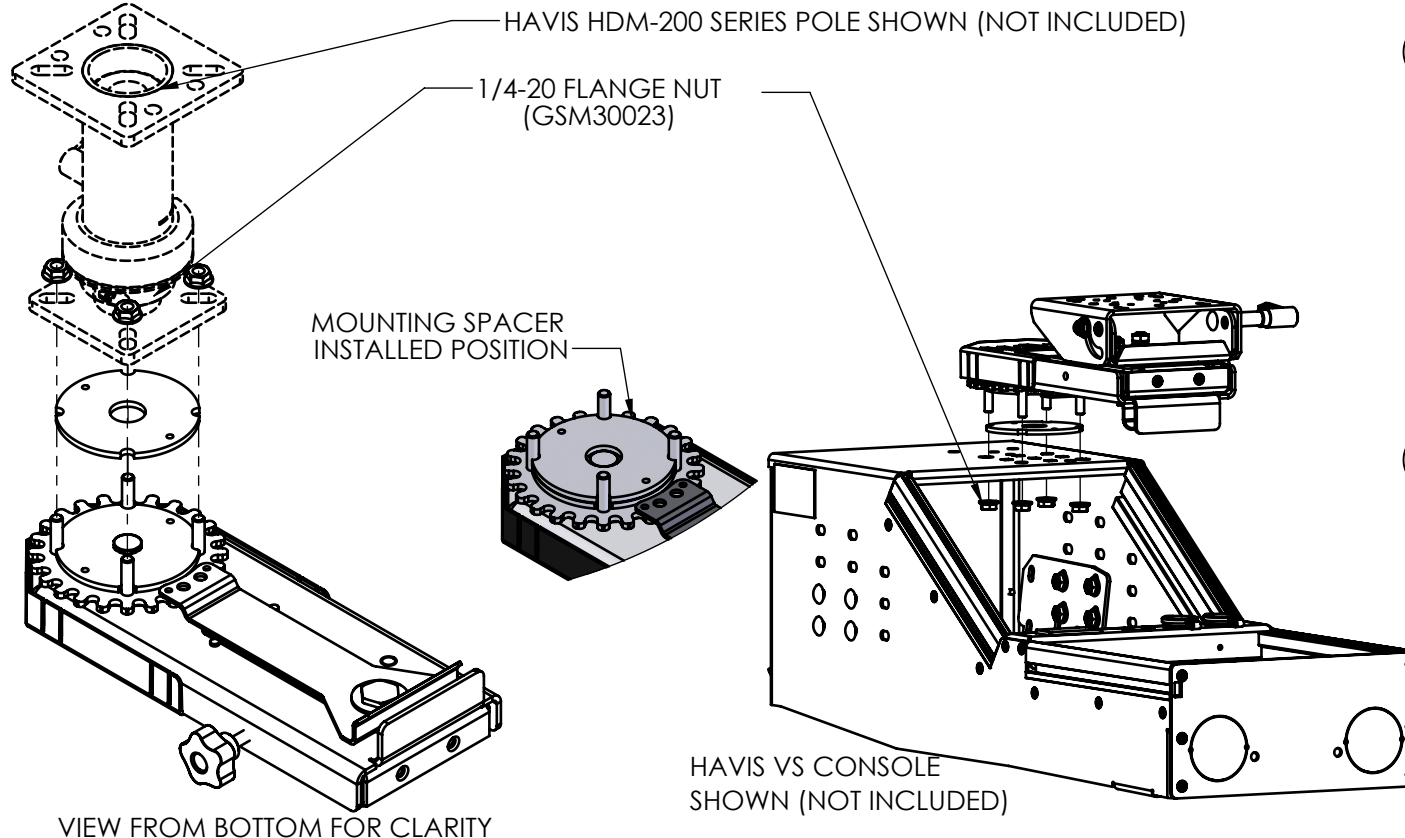

VIEW FROM BOTTOM FOR CLARITY

DRILL TEMPLATE

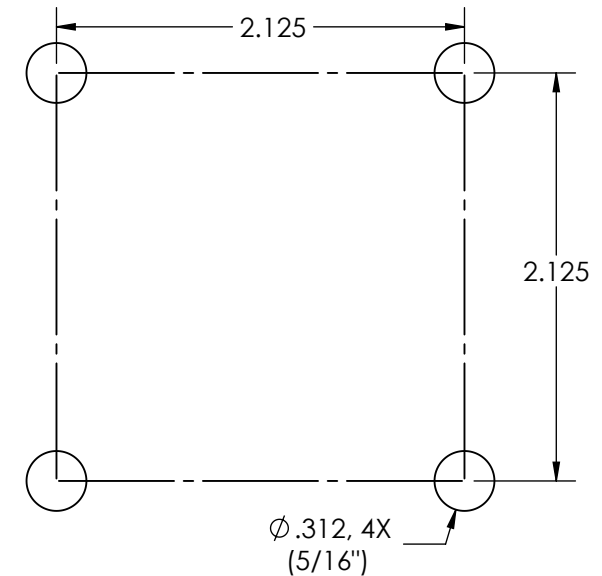

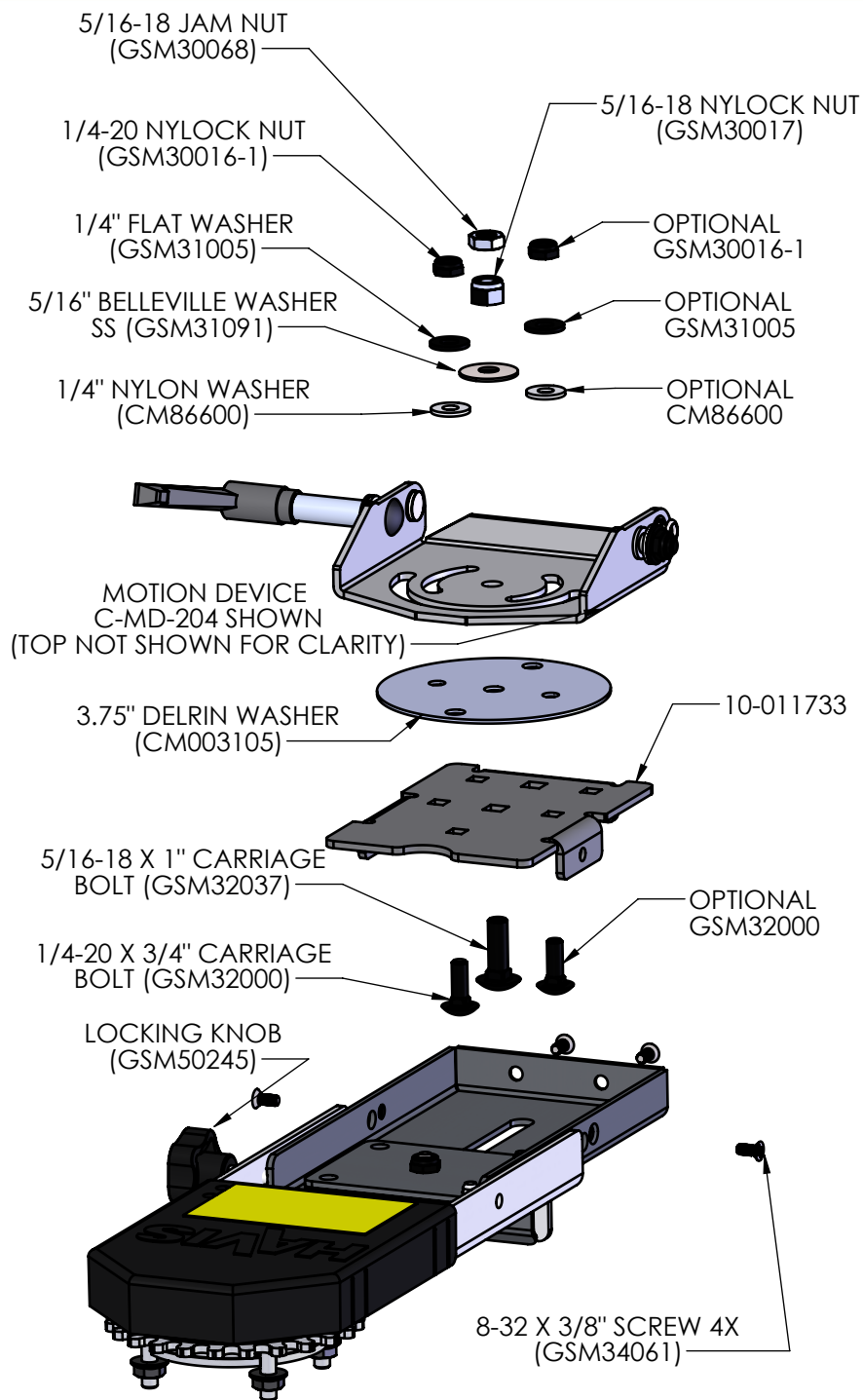

MOTION DEVICE INSTALLATION (C-MD-114) AND OPTIONAL TILT/SWIVEL POSITIONS (C-MD-112 AND C-MD-119)

- LOOSEN KNOB AND FULLY EXTEND SLIDE TRAY TO PROVIDE ACCESS TO THE (4) GSM34061 SCREWS.
- REMOVE SCREWS AND REMOVE PLATE 10-011733 FROM ASSEMBLY.
- SELECT DESIRED MOUNTING POSITION AND CARRIAGE BOLT PATTERN FROM THE POSITIONS SHOWN BELOW. OPTIONAL MOUNTING POSITION PROVIDES ADDITIONAL CLEARANCE FOR MOTION DEVICE ROTATION IN VERTICAL TABLET MOUNTING APPLICATIONS WHEN USING C-MD-202 OR C-MKM-102.
- INSERT CARRIAGE BOLTS FROM BOTTOM THROUGH 10-011733, CM003105, AND MOTION DEVICE BASE. USE THE BOLT PATTERN BELOW THAT CORRESPONDS WITH THE DESIRED ROTATION OF DEVICE.
- INSTALL WASHERS, NUTS, AND JAM NUTS FOLLOWING THE ORDER SHOWN IN THE EXPLODED VIEW TO LEFT.
- REINSTALL PLATE 10-00733 AND (4) GSM34061 SCREWS.
- REFER TO USER ADJUSTMENTS PAGE FOR INFORMATION ON ADJUSTING ROTATIONAL FORCE OF DEVICE.

MOUNTING POSITIONS:

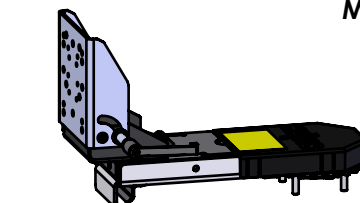

C-MD-200 SERIES SHOWN IN
OPTIONAL POSITION FOR
ADDITIONAL CORNER CLEARANCE

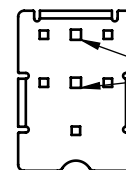

STANDARD POSITION FOR CENTER
CARRIAGE BOLT (GSM32037)

CARRIAGE BOLT PATTERNS:

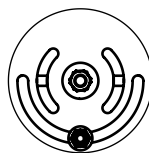

STANDARD
180° ROTATION
(AS SHIPPED)

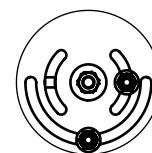

OPTIONAL
90° ROTATION
(ADD SUPPLIED 1/4"
HARDWARE AS SHOWN)

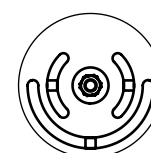

OPTIONAL
*360° ROTATION
(DO NOT USE 1/4" HARDWARE)

*NOTE: OPTIONAL 360° MOUNTING IS NOT RECOMMENDED FOR MOUNTING DEVICES HEAVIER THAN A KEYBOARD.

USER ADJUSTMENTS

MOTION DEVICE ROTATION

NOTE: TILT/SWIVEL MOTION DEVICE SHOWN. OTHER MOTION DEVICES MAY BE SUBSTITUTED.

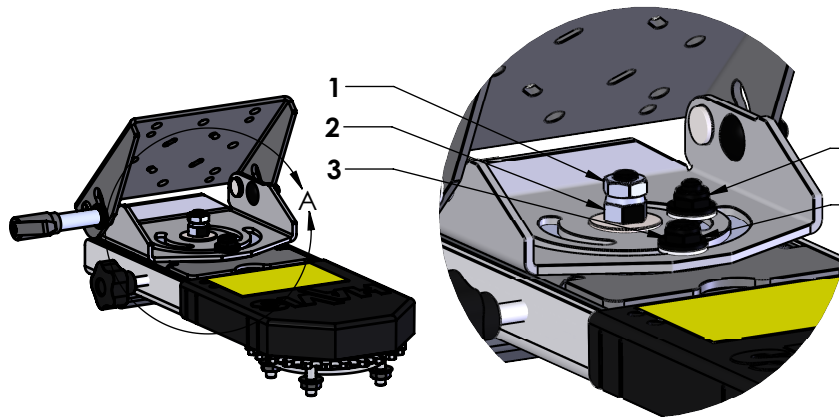

(OPTIONAL 90° ROTATION CONFIGURATION)

(STANDARD 180° ROTATION CONFIGURATION)

USING A 1/2" SOCKET, LOOSEN NUT 1 AND ADJUST NUT 2 WITH A 1/2" OPEN END WRENCH AS REQUIRED TO ACHIEVE CUSTOMER DESIRED ROTATIONAL FORCE OF MOTION DEVICE. RETIGHTEN NUT 1 WITH A 1/2" SOCKET WHILE RESTRICTING NUT 2 FROM TURNING WITH A 1/2" OPEN END WRENCH.

FOR MINOR ADJUSTMENT, TIGHTEN OR LOOSEN NUT 3 USING A 7/16" SOCKET.

DETAIL A

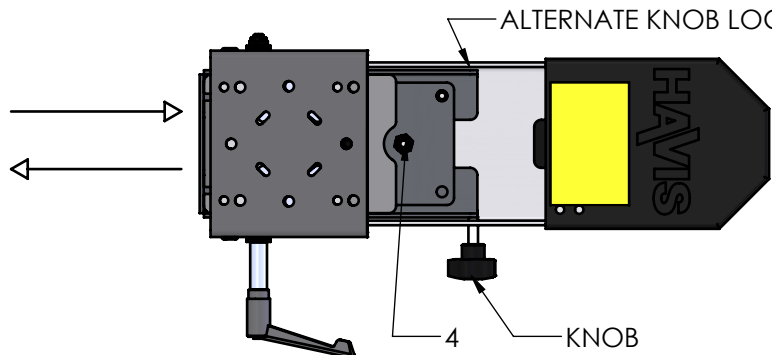

ALTERNATE KNOB LOCATION **SLIDE TRAY**

USING A 7/16" SOCKET, TIGHTEN/LOOSEN NUT 4 AS REQUIRED TO ACHIEVE CUSTOMER DESIRED SLIDING FORCE OF SLIDE TRAY.

KNOB CAN BE TIGHTENED TO LOCK SLIDE TRAY IN ANY POSITION. STORE WITH SLIDE TRAY FULLY COLLAPSED AND KNOB TIGHTENED. KNOB CAN BE INSTALLED ON EITHER SIDE OF DEVICE AT USER'S PREFERENCE.

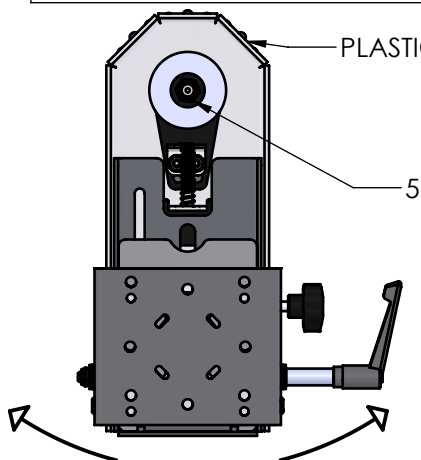

PLASTIC COVER NOT SHOWN IN THIS VIEW

UNIT ROTATION

REMOVE PLASTIC COVER BY PULLING UPWARDS TO UNSNAP SIDE CLIPS. USING A 9/16" SOCKET, TIGHTEN/LOOSEN NUT 5 AS REQUIRED TO ACHIEVE CUSTOMER DESIRED ROTATIONAL FORCE OF DEVICE WHEN RELEASE LEVER IS PULLED. REINSTALL PLASTIC COVER BY PUSHING DOWNWARD TO ENGAGE SIDE CLIPS.

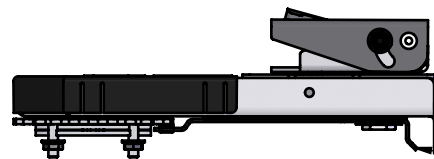

RELEASE LEVER

INSTRUCTIONS FOR OPTIONAL REINFORCEMENT PLATES OF C-MD-200 SERIES

GSM30017
5/16-18 NYLOCK NUT

GSM31006
5/16 FLAT WASHER

GSM30016-1 OPTIONAL
1/4-20 NYLOCK NUT
GSM31005 OPTIONAL
1/4 FLAT WASHER
CM86600 OPTIONAL
1/4 PLASTIC WASHER

GSM30016-1
1/4-20 NYLOCK NUT

GSM31005
1/4 FLAT WASHER

CM86600
1/4 PLASTIC WASHER

GSM31310
5/16 PLASTIC WASHER

DEPENDING ON
APPLICATION THE
CENTER PIVOT BOLT
MAY REQUIRE 1/4"
HARDWARE

ADDITIONAL
CM003105 LARGE PLASTIC WASHER
(INCLUDED ONLY IN
C-MD-206 AND C-MD-207)
INSTALL REINFORCEMENT PLATE
ON THIS SIDE WHEN USED
IN FLM APPLICATIONS

CM003105
LARGE PLASTIC
WASHER

CM003103-1
REINFORCEMENT PLATE

MOUNTING
PLATFORM

GSM31091
BELLEVILLE WASHER

GSM31005
1/4" FLAT WASHER

GSM33003
1/4"-20 X 1-1/4" LG
HHCS

DEPENDING ON
APPLICATION THE
CENTER PIVOT BOLT
MAY REQUIRE 1/4"
HARDWARE

GSM33013
5/16-18 X 1-1/4" LG
HHCS

DEPENDING ON
APPLICATION THE
CENTER PIVOT BOLT
MAY REQUIRE 1/4"
HARDWARE

GSM31005
1/4" FLAT WASHER
OPTIONAL

GSM33003
1/4-20 X 1-1/4" LG HHCS
OPTIONAL

INSTRUCTIONS FOR OPTIONAL REINFORCEMENT PLATES OF C-MD-200 SERIES

