

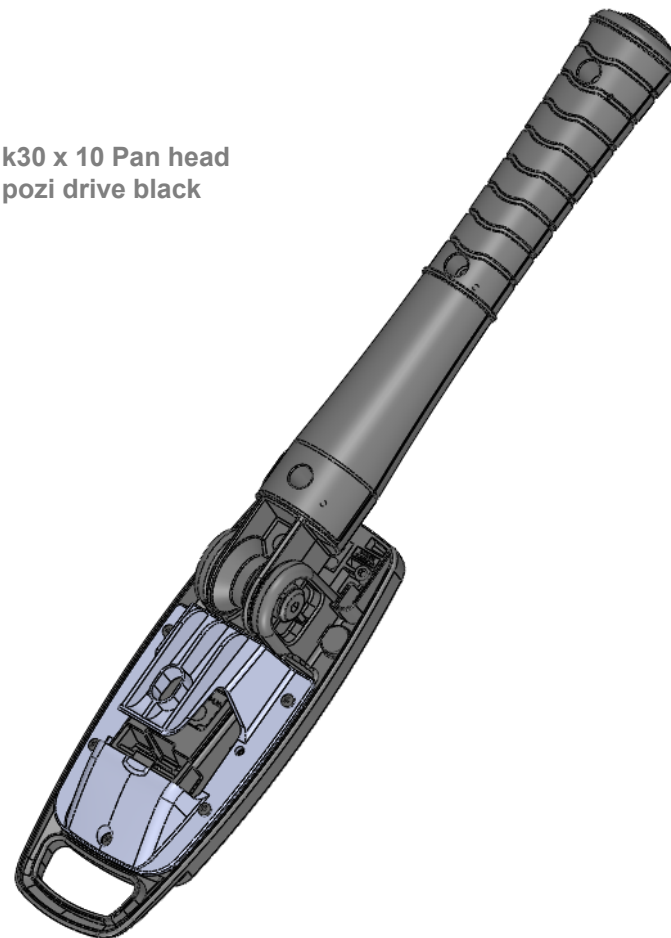

# Wall Mount & Plinth Bracket

## Quick Installation Guide

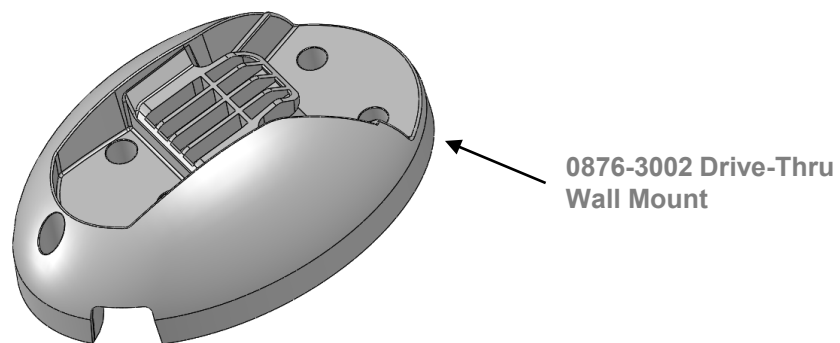
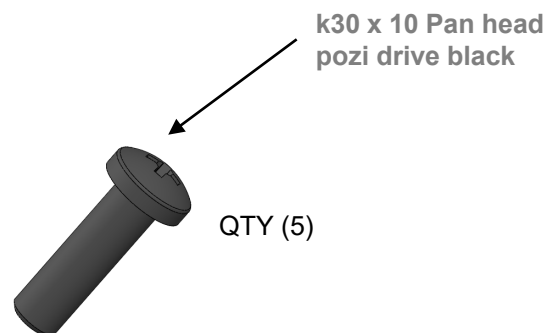
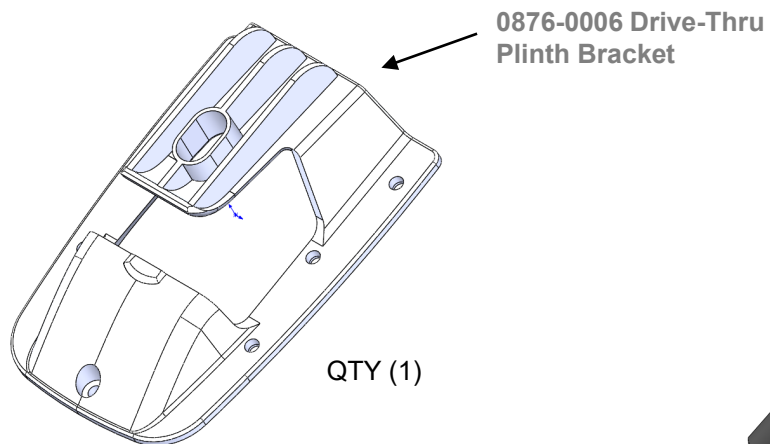

#### TOOLS

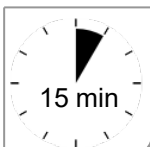
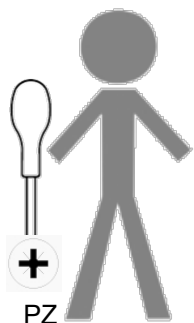

#### PARTS



QTY (1)



QTY (5)



QTY (1)

1

Line up the Plinth Bracket and plinth so the holes are concentric. The 5 screw hole positions used are circled red.

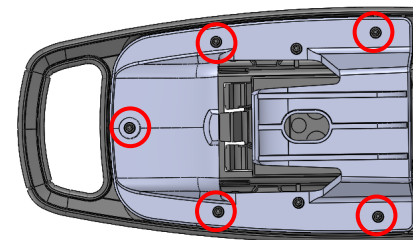

2

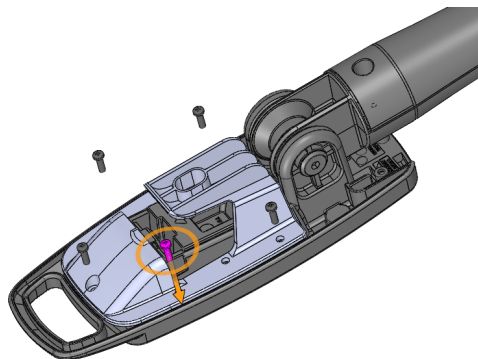

Fit screws in indicated location hand tight. Do not over tighten.

3

Print out the Wall Mount Template on A4 paper and mark with a centre punch or marker pen through the indicated screw boss holes onto the surface that the screws will be located on.

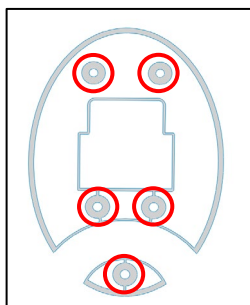

Using suitable screws for the wall being mounted to, mount in the five locations marked out in the previous step.

4

Engage and remove the handle vertically from the wall mount making sure the tongue on the plinth bracket falls behind the tongue on the wall mount. Note, the Drive-Thru Handle must be straight (not bent at the pivot point) in order to be mounted in the wall mount

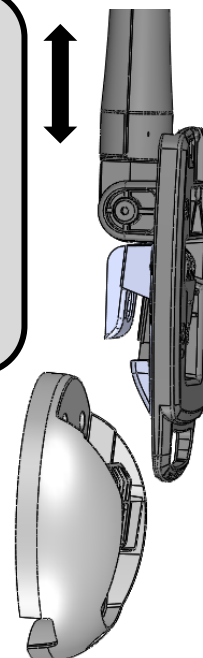

Must be printed at A4  
To scale correctly

